

## Representation of parts: Pulsor type 150 with impulse nozzle

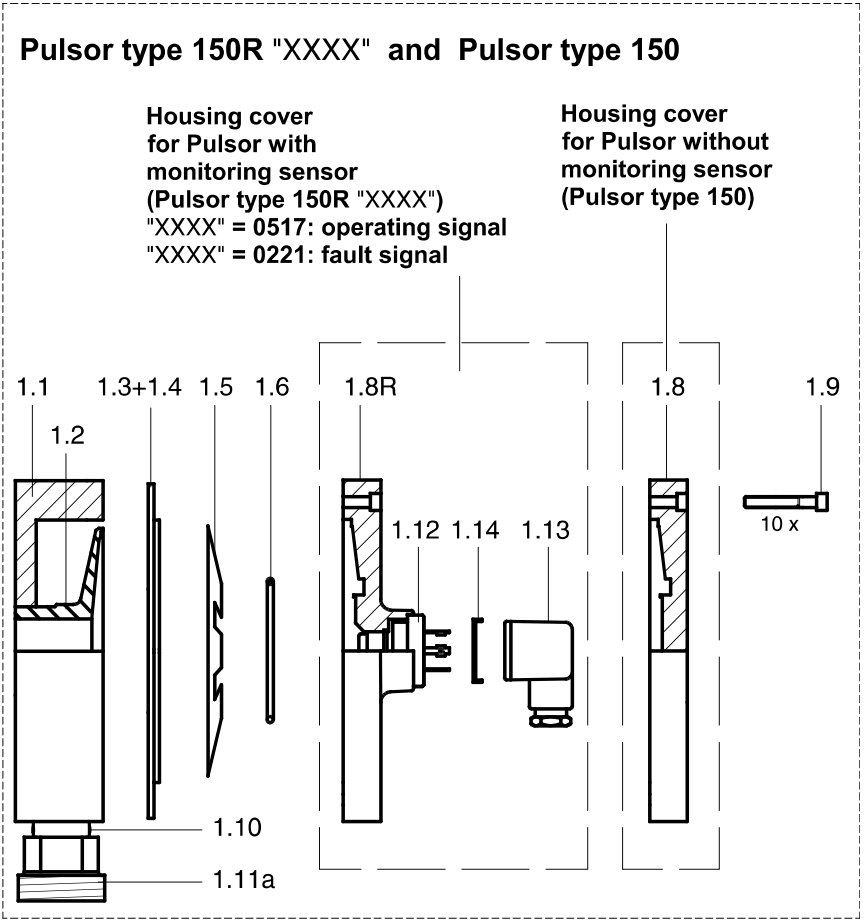
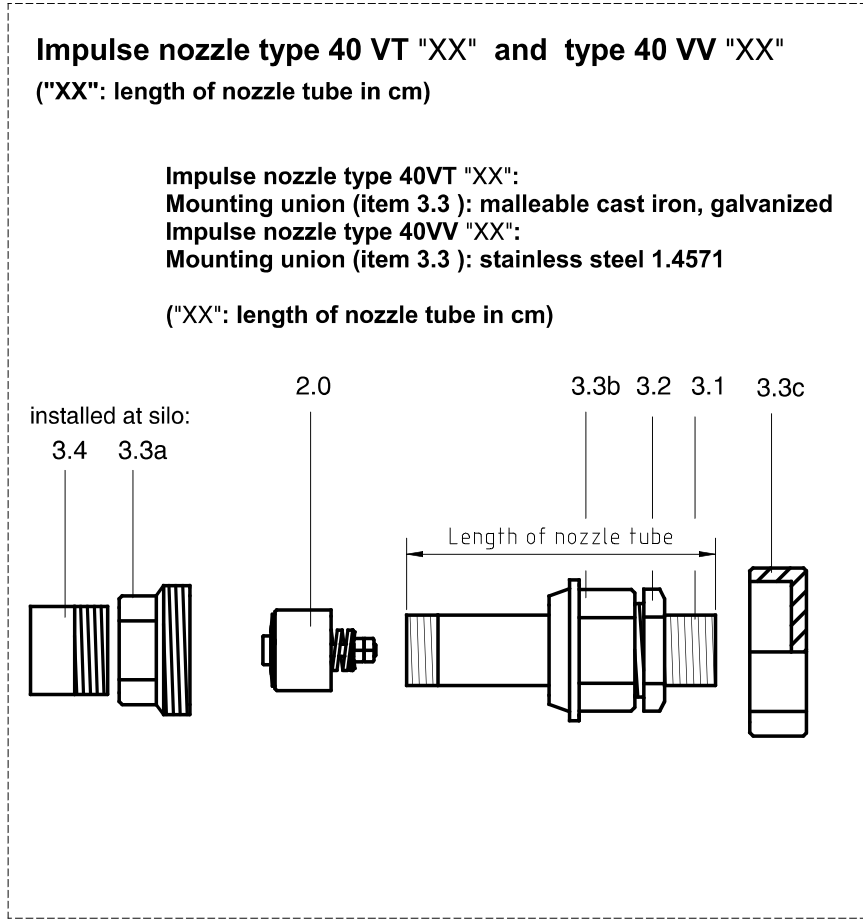

Impulse nozzle type 40 VT "XX" and type 40 VV "XX"	
150-2.0 *	Nozzle head, 1.4112
150-3.1+3.2	Nozzle tube (3.1) with reducer (3.2), length "XX" (see below), 1.4571
150-3.3a	Pipe union, screw-in part, MCI galv. (type VT) or 1.4404 (Typ VV)
150-3.3b	Pipe union, insert part, MCI galv. (type VT) or 1.4404 (Typ VV)
150-3.3c	Pipe union, union nut, MCI galv. (type VT) or 1.4404 (Typ VV)
150-3.4	Weld-on nipple, R 1½"
	XX=130mm =>type 40 VT13 / VV13
	XX=180mm =>type 40 VT18 / VV18
	XX=140mm =>type 40 VT14 / VV14
	XX=210mm =>type 40 VT21 / VV21
	XX=160mm =>type 40 VT16 / VV16
	XX=220mm =>type 40 VT22 / VV22
* Wear parts	

Pulsor type 100R and type 100	
150-1.1+1.2	Housing bottom with seat plate, AlSi10Mg/AlZnSiCu
150-1.3+1.4 *	Sealing diaphragm with valve disk, CR-PA/1.4021
150-1.5 *	Plate spring, 51CrV4
150-1.6 *	Seat ring, 51CrV4
150-1.8	Housing cover, AlSi10Mg
150-1.8R+1.12	Housing cover (1.8R) with sensor (1.12) no. 0517 or no. 0221
150-1.9	Hexagon screw, 1.4301
150-1.10	Pipe double nipple, 1.4571
150-1.11a	Pipe union, screw-in part, malleable cast iron (MCI), galv
150-1.13	Angle plug
150-1.14	Sealing
* Wear parts	